

CHARACTERISTICS

- EASIER MAINTENANCE AS ELEMENTS MOUNTED TO BASE CAN BE EXCHANGED QUICKLY IN EVENT IF DAMAGED - NO NEED TO REPLACE ENTIRE FEEDER.
- REDUCED SPARE PARTS, FEWER PARTS IN STOCK = LOWER INVENTORY COSTS.
- METERING VALVES CAN BE SERVICED WITHOUT DISTURBING THE ASSEMBLY OR EXISTING PIPE WORK.
- LOWER MAINTENANCE COSTS; THE MODULAR CONCEPT PROVIDES LOWER COST REPLACEMENT COMPONENTS
- FLEXIBILITY TO EXPAND OR REDUCE THE NUMBER OF ELEMENTS TO MEET CHANGING REQUIREMENTS.

DM X-OVER SUB-BASE

THE EASY WAY TO GO MODULAR ON YOUR EXISTING TRADITIONAL DUAL LINE SYSTEM

The **DM- XOVER** Sub-base allows customers with traditional non modular dual line products to effortlessly switch over to a modular design concept and take immediate advantage of the numerous benefits modularity brings.

THE DM X-OVER SYSTEM CONSISTS OF TWO MAIN PARTS:

- An interchangeable Base with traditional Dual Line systems.
- 1 to 4 - Standard DM Metering Valves.

Metering Valves can be assembled on the single base to the number of outputs required. (From 1 to 8)

Standard Modular DM Metering Valves with adjustable or fixed discharge can be used. The Valves with adjustable discharge are fitted with turrets, integral adjusting screws, methacrylic cover and seal.

A blanking plate (ordered separately) can be used to accommodate additional points that may need to be installed in the future.



The **DM-XOVER** series Base plates allows you users to replace non modular dual line elements (typically with 1 – 4 turrets) with a new base plates that has exact interchangeable piping connections as its existing non-modular counterpart.

This **sub-base plate** accommodates off-the-shelf Dropsa **modular dual line valves**.

Once the sub-base plate is in place you will not have to touch your tubing again to replace dual line valves.

DM-XOVER series Base plates

Non modular dual line elements

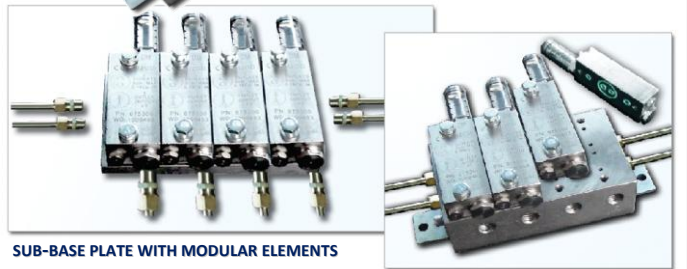

SUB-BASE PLATE WITH MODULAR ELEMENTS

APPLICATION

ANY EXISTING TRADITIONAL MONOBLOCK DUAL-LINE SYSTEM

THE DROPSA DM DUAL LINE VALVES ARE THE PREFERRED CHOICE OF MANY STEEL MACHINERY OEM AND CUSTOMERS FOR GREASE LUBRICATION VALVES WITH PROVEN LEVELS OF RELIABILITY AND REPRESENTS EXCELLENT VALUE FOR MONEY.

Consider some important facts about Dropsa's modular dual line valve.

- Made in high quality hard nickel plated steel, up to 70 times more resistant than zinc plated steel.
- Also available in Stainless 316 Steel for ultra harsh environments
- Micron level honing and grinding production process for high performance spool and body matching provides extended product life and high numbers of cycles.
- Specially designed Viton sealing technology for a long leak free life, even when using oil instead of grease.
- Manufactured and assembled at our high-tech production facility and individually tested to exacting quality standard using the latest in industrial automation.
- CE and ATEX certification as standard.

DIMENSIONS (1:2 SCALE)

1 MODULE

0673161

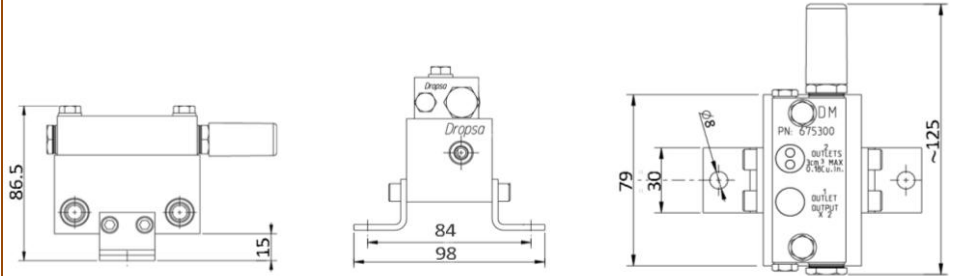
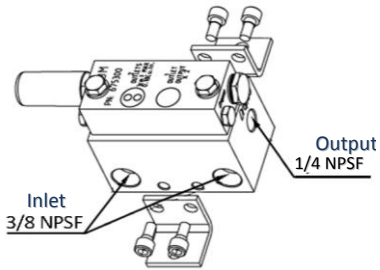

2 MODULES

0673162

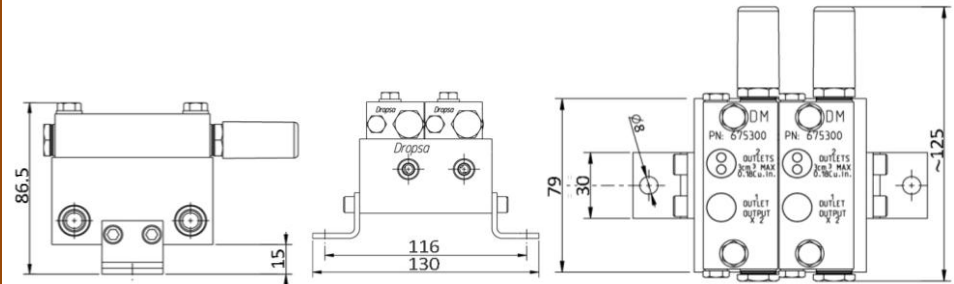
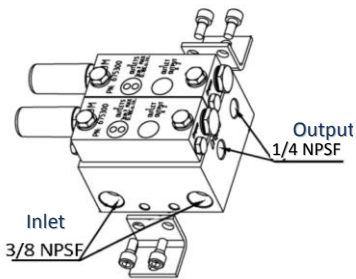

3 MODULES

0673163

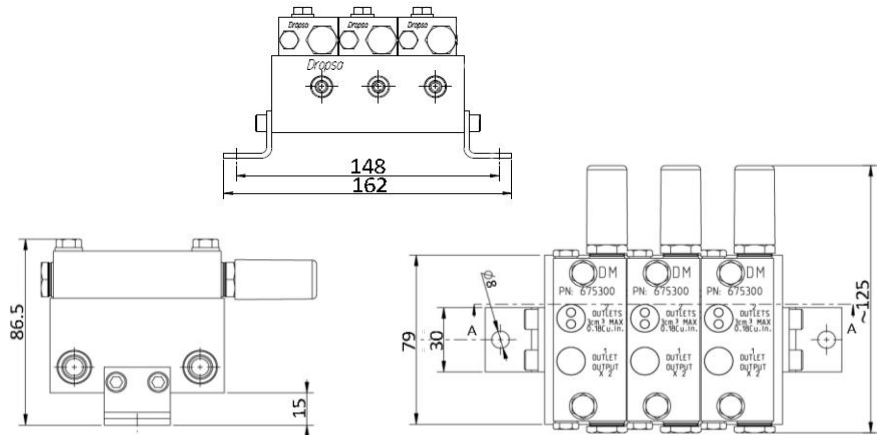
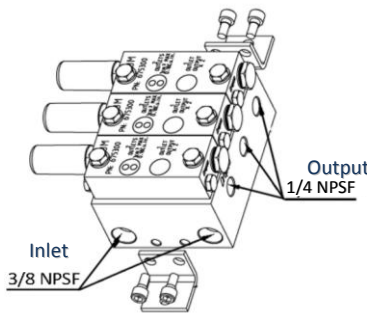

4 MODULES

0673164

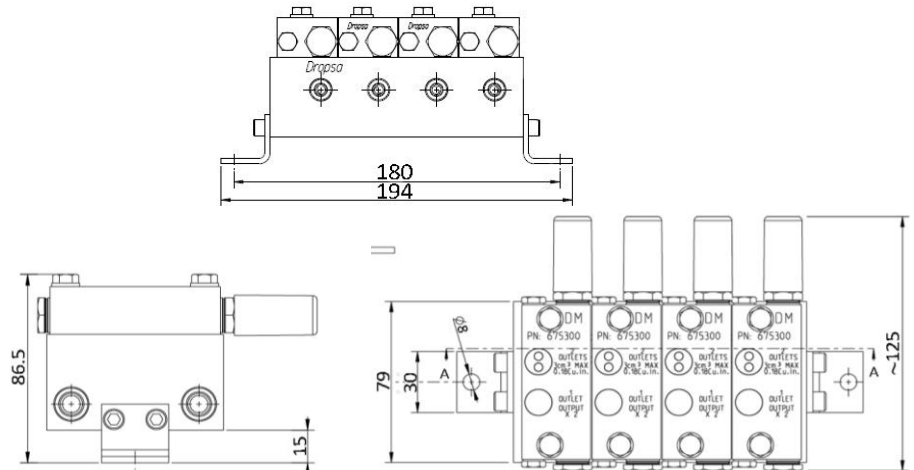
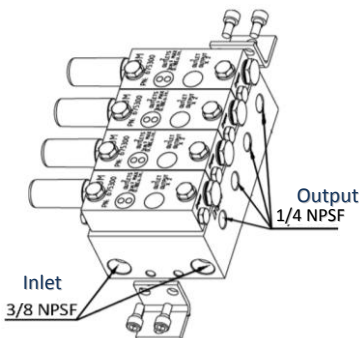

1 MODULE

0673171

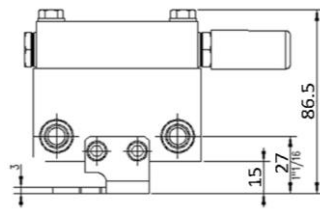
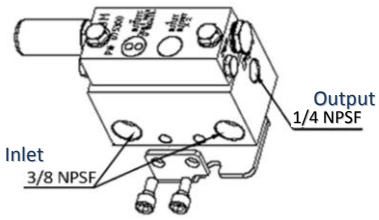

SECTION A-A

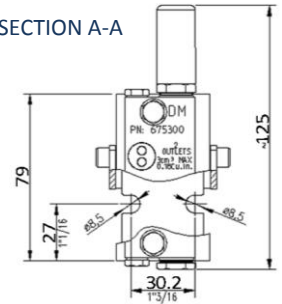

2 MODULES

0673172

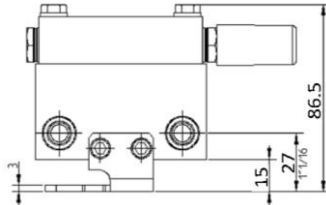
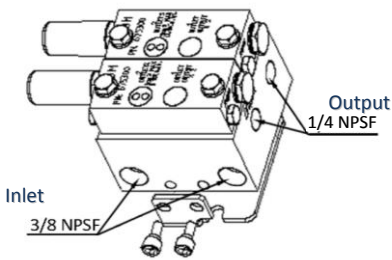

SECTION A-A

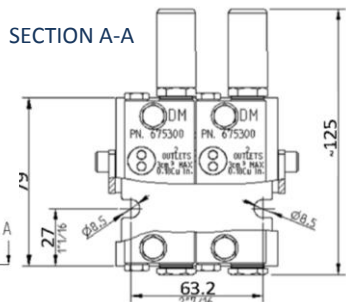

3 MODULES

0673173

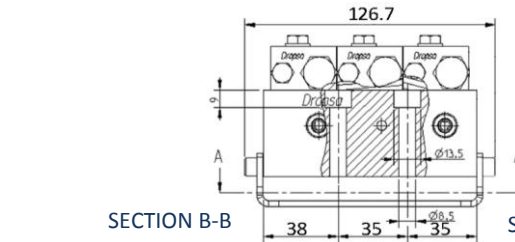
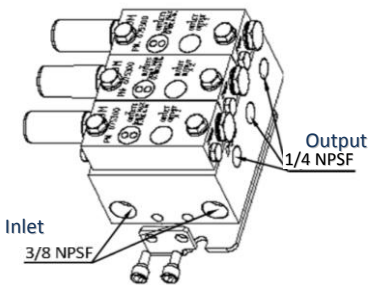

SECTION B-B

SECTION A-A

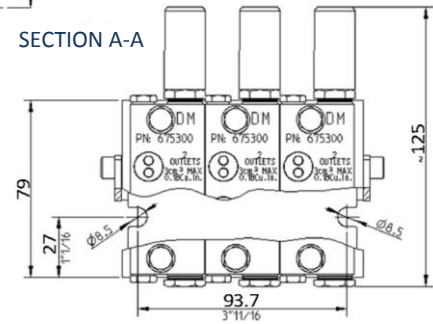
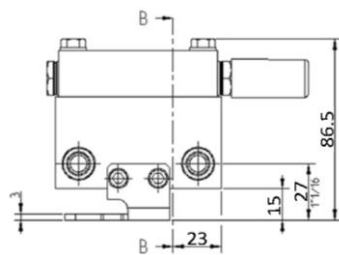

4 MODULES

0673174

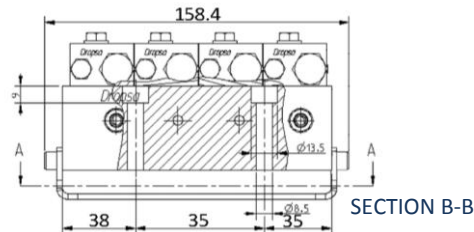
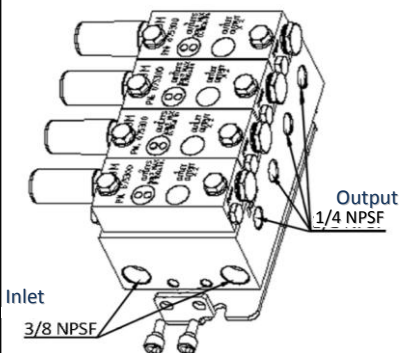

SECTION B-B

SECTION A-A

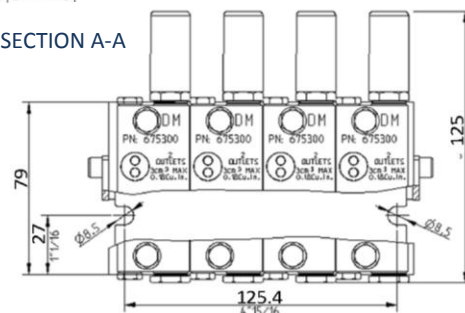
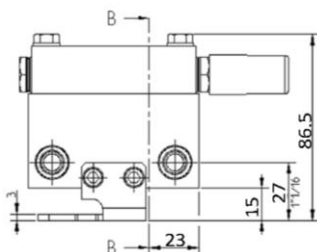



CONTACTS

www.dropsa.com

sales@dropsa.com

ITALIA

Dropsa SpA
t. (+39) 02-250791
f. (+39) 02-25079767

U.K.

Dropsa (UK) Ltd
t. (+44) 01784-431177
f. (+44) 01784-438598

GERMANY

Dropsa GmbH
t. (+49) 0211-394-011
f. (+49) 0211-394-013

FRANCE

Dropsa Ame
t. (+33) 01-3993-0033
f. (+33) 01-3986-2636

U.S.A.

Dropsa Corporation
t. (+1) 586-566-1540
f. (+1) 586-566-1541

AUSTRALIA

Dropsa Australia Ltd.
t. (+61) 02-9938-6644
f. (+61) 02-9938-6611

BRAZIL

Dropsa Do Brazil
t. (+55) 011-563-10007
f. (+55) 011-563-19408

CHINA

Dropsa Lubrication
Systems
(Shanghai) Co., Ltd
t. (+86) 021 67740275
f. (+86) 021 67740205

TECHNICAL INFORMATION

TECHNICAL CHARACTERISTICS	
Lubricant	Min. Viscosity: 100 cST, Grease Max: 265 ASTM (NLGI2)
Working temperature	-30 ÷ + 80°C -22 ÷ +176 fahrenheit
Max working pressure (inlet)	400 bar
Frequency	100 cycles/minute
Lubricant	Inlets: 3/8"NPTF - Outlets:1/4" NPTF
Flow rate	From 0,25 cc to 3 cc

ORDERING INFORMATION

BASE MODELS	
DESCRIPTION	PART NUMBER
DM X-OVER 1-2 station interchange DD- 42 o DD 52	0673161
DM X-OVER 2-4 station interchange DD- 42 o DD 52	0673162
DM X-OVER 3-6 station interchange DD- 42 o DD 52	0673163
DM X-OVER 4-8 station interchange DD- 42 o DD 52	0673164
DM X-OVER 1-2 station	0673171
DM X-OVER 2-4 station	0673172
DM X-OVER 3-6 station	0673173
DM X-OVER 4-8 station	0673174

KIT + FEEDERS	
DESCRIPTION	PART NUMBER
Base + feeders kit 1-2 outlets	3133551
Base + feeders kit 2-4 outlets	3133552
Base + feeders kit 3-6 outlets	3133553
Base + feeders kit 4-8 outlets	3133554

SPARE PARTS			
DESCRIPTION	PART NUMBER	DESCRIPTION	PART NUMBER
mod.valve 3cc avp	675300	Bracket kit + screws 673173	3133543
Bracket kit + screws 673171	3133541	Bracket kit + screws 673174	3133544
Bracket kit + screws 673172	3133542	Bracket kit + screws 673161-4	3133545