



# FEEDER BLOCK SERIES APF05-APF1

Fixed Discharge APF05 0,5 cc. APF1 1 cc. per/stroke  
(APF05 .030 cu.in./stroke APF1 .061 cu.in./stroke)  
Dual Line System.

622060 622070  
623060 623070  
624060 624070  
625060 625070  
622080 622090  
623080 623090  
624080 624090  
625080 625090

ENGLISH

## PRODUCT DATA SHEET

### DESCRIPTION:

The feeder body is made of special anti-friction steel. Pistons are made of tempered steel. Bores and pistons are lapped to provide superior sealing. These feeders do not employ indicator turrets (see AP1 series) and are used for special applications. The body has a galvanized finish and features an adaptor (see Fig. F.) for single or double outlet conversion. They are set by the factory 0,5 cc. per/stroke (.030 cu.in./stroke) for APF05 and at 1 cc. per/stroke (.061 cu.in./stroke) for APF1 unless otherwise requested.



### SPECIFICATION:

**Temperature range:** -30 to +80°C.  
**Max. pressure (inlet):** 400 bar (5800 psi.)  
**Cycles:** 100/min.  
**Min. viscosity:** 100cSt (462 SSU)  
**Grease Max.** 265 ASTM (NLGI 2)\*  
**Connections:**  
**Inlet:** 1/4"  
**Outlet:** 5/16"-24NF

(\* For different type of grease please contact your supplier

### ORDERING INFORMATION:

Ordering is by Part No. refer to the following table:

Thread	Part No.		Weight.		No. Outlets.
	APF05	APF1	Kg.	Lbs.	
DropSA Standard BSP.	622060	622070	0,430	.94	1-2
	623060	623070	0,620	1.36	2-4
	624060	624070	0,840	1.85	3-6
	625060	625070	1,00	2.20	4-8
NPTF	622080	622090	0,430	.94	1-2
	623080	623090	0,620	1.36	2-4
	624080	624090	0,840	1.85	3-6
	625080	625090	1,00	2.20	4-8

### INSTALLATION/OPERATION:

**Function:**(Refer to Figs. 1 and 3.)The feeder discharge is controlled by a servo piston (A) and metering piston (B) and can be arranged to provide a single or double outlet.

Fig D-E = 2 separate outlets. Fig F = connecting bridge for single outlet.

Feeders are normally supplied with double outlets unless otherwise specified. For single outlets use Connecting Bridge **Part No. 622030 (refer to Fig. 3.)**. When single outlet feeders are used, the discharge per complete cycle = for APF05 0,5 - 1 cc./stroke (.030 - .061 cu.in./stroke) and for APF1 1 - 2 cc./stroke (.061 - .122 cu.in./stroke).

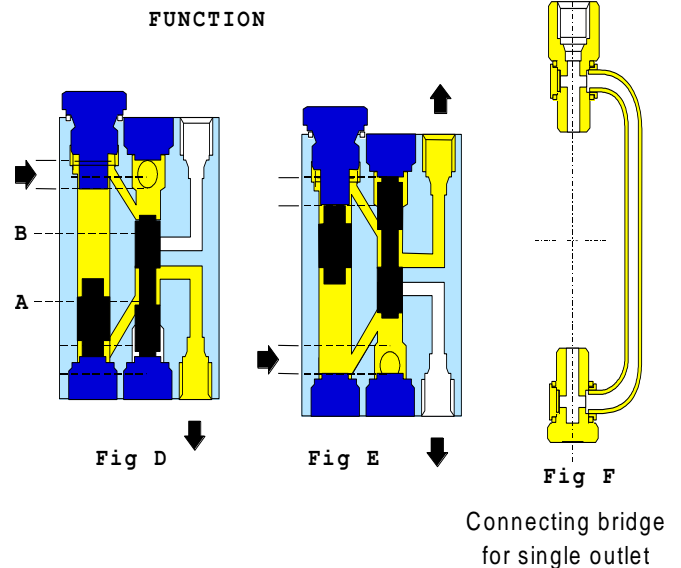

**Dimensions:** (Refer to Fig. 2.)

**Mounting:** (Refer to Fig. 4.) Aluminium Bushings **Part No. 622017** are supplied for mounting on uneven surfaces to prevent distortion or damage due to overtightening.

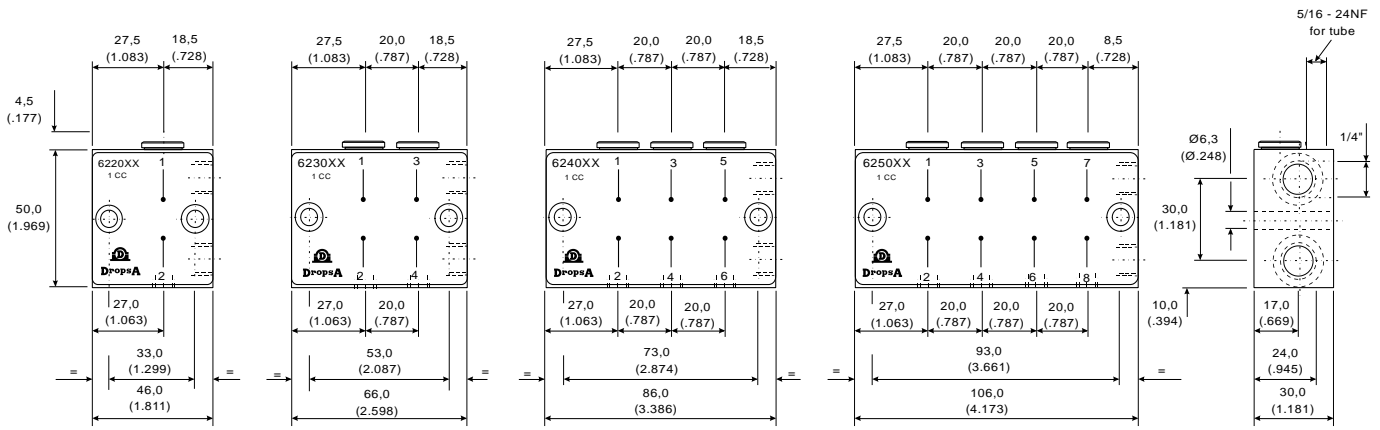

DROPSA STANDARD - DIN 3852 Ø mm				
Plug	Ø Tube	Nut	Ring	Fitting
926001	6	91396	91590	92337
	8	91402	91596	92266
	10	91406	91601	92242
NPTF DRY SEAL Ø INCHES				
850281	1/4	850200	850220	850250
	5/16	850201	850221	850252
	3/8	850202	850222	850254

DROPSA STANDARD - Ø mm			
Cone	Bush	Ø Tube	Plug
93004	92004	4	91005
NPTF DRY SEAL Ø INCHES			
93004	92026	Ø 5/32	91005

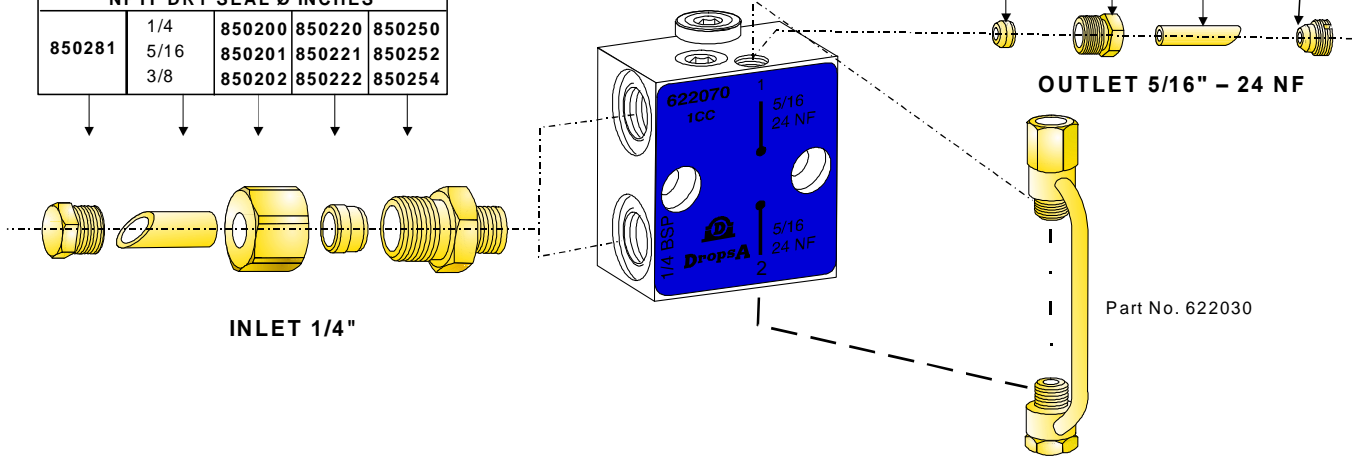

INLET 1/4"

OUTLET 5/16" - 24 NF

Part No. 622030

The fixing parts which are indicated thus \* are to be ordered separately.

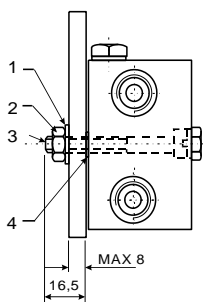

Pos	Part No.	Qty.	Description	
*1	16009	2	Spring washer	Metric
*2	16335	2	Nut M6	
*3	12534	2	Screw M6 x 45	
4	622017	2	Bushing	
*1	16012	2	Spring washer	Inches
*2	16499	2	Nut 1/4-28 UNF Hex. 7/16	
*3	12562	2	Screw 1/4-28 UNF x 1 3/4	
4	622017	2	Bushing	

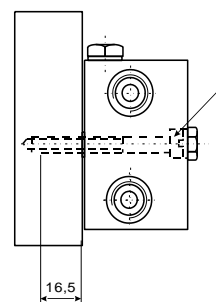

WELD PLATES FOR FEEDERS

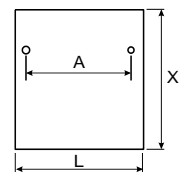

N.	Part No.	DIMENSIONS (INCHES)		
		A	L	X
1	111585	33 (1.29)	45 (1.77)	120 (4.72)
2	111586	53 (2.08)	65 (2.55)	120 (4.72)
3	111587	73 (2.87)	85 (3.34)	120 (4.72)
4	111588	93 (3.66)	105 (4.13)	120 (4.72)

**ITALIA**  
Dropsa SpA  
t. +39 02-250791  
f. +39 02-2507976

**U.K.**  
Dropsa (UK) Ltd  
t. +44 (0)1784-431177  
f. +44 (0)1784-438598

**GERMANY**  
Dropsa GmbH  
t. +49 (0)211-394-011  
f. +49 (0)211-394-013

**FRANCE**  
Dropsa Ame  
t. +33 (0)1-3993-0033  
f. +33 (0)1-3986-2636

**CHINA**  
Dropsa Lubrication Systems  
(Shanghai) Co., Ltd  
t. +86 (021) 67740275  
f. +86 (021) 67740205

**U.S.A.**  
Dropsa USA Incorporated  
t. +1 586-566-1540  
f. +1 586-566-1541

**AUSTRALIA**  
Dropsa Australia Pty  
t. +61 (02)-9938-6644  
f. +61 (02)-9938-6611

**BRAZIL**  
Dropsa Do Brasil Ind.e  
Com.Ltda  
t. +55 (0)11-563-10007  
f. +55 (0)11-563-19408

© Copyright Dropsa - all rights reserved. Reproduction of any part of this document is strictly forbidden without prior consent from Dropsa. Dropsa reserves the right to modify specifications without prior notice.