



# FEEDER BLOCK SERIES AP6F

Fixed Discharge 1,5cc. per stroke  
 (.091 cu.in./stroke)  
 Dual Line System

622190 623190  
 624190 625190  
 622180 623180  
 624180 625180  
 622140 623140  
 624140 625140

ENGLISH

## PRODUCT DATA SHEET

### DESCRIPTION:

The feeder body is made of special anti-friction steel. Pistons are made of tempered steel. Bores and pistons are lapped to provide superior sealing. These feeders do not employ indicator turrets (see AP6 series) and are used for special applications. The body has a galvanized finish and features an adaptor for single or double outlet conversion. They are set by the factory at 1,5 cc./stroke(.091 cu. in./ stroke) unless otherwise requested.

### SPECIFICATION:

**Temperature range:** -30 +80°C.(-22+176°F.)  
**Max. pressure (inlet):** 400 bar (5800 psi.)  
**Cycles:** 100/min.  
**Min. Viscosity:** 100 cSt (462 SSU)  
**Grease Max.:** 265 ASTM (NLGI 2)\*  
**Connections:**  
**Inlet:** 1/4"  
**Outlet:** 1/4"

(\*) For different type of grease please contact your supplier

### ORDERING INFORMATION:

Ordering is by Part No., refer to the following table:

Thread	Part No.	Weight.		No. outlets
		Kg.	Lbs.	
Dropsa Standard BSP	622180	0,820	1.80	1 - 2
	623180	1,230	2.71	2 - 4
	624180	1,560	3.44	3 - 6
	625180	1,920	4.23	4 - 8
Din 3852 x BSP	622190	0,820	1.80	1 - 2
	623190	1,230	2.71	2 - 4
	624190	1,560	3.44	3 - 6
	625190	1,920	4.23	4 - 8
NPTF	622140	0,820	1.80	1 - 2
	623140	1,230	2.71	2 - 4
	624140	1,560	3.44	3 - 6
	625140	1,920	4.23	4 - 8

### INSTALLATION/OPERATION:

**Function:(Refer to Figs. 1 and 3.)**

In installations where backpressure is detected at the outlets of the feeder blocks, a check- valve must be fitted to each outlet. The feeder discharge is controlled by a servo-piston (A) and metering piston (B) and can be arranged to provide a single or double outlet. Fig. D-E= 2 separate outlets Fig. F-G =1 outlet. Feeders are normally supplied with double outlets unless otherwise specified. Retrospective conversion can be undertaken by fitting adaptor Y (**Part No. 622076**) for single outlet and X (**Part No. 622077**) for double outlet. When single



outlet feeders are used the discharge per complete cycle = 3 cc./stroke (.183 cu.in. / stroke).

### Dimensions:

**Mounting: (Refer to Fig. 2.)**

Aluminium bushings (**Part. No. 3008107**) are supplied for mounting on uneven surfaces to prevent distortion or damage due to overtightening.

### FUNCTION

#### 2 OUTLETS

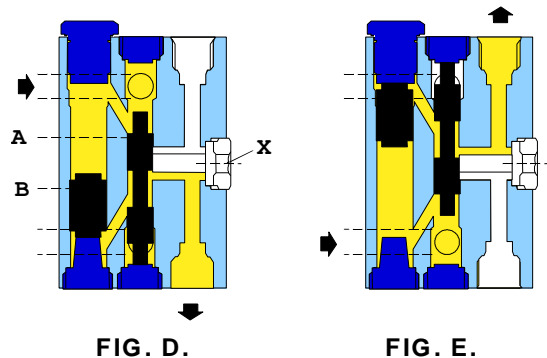

#### 1 OUTLET

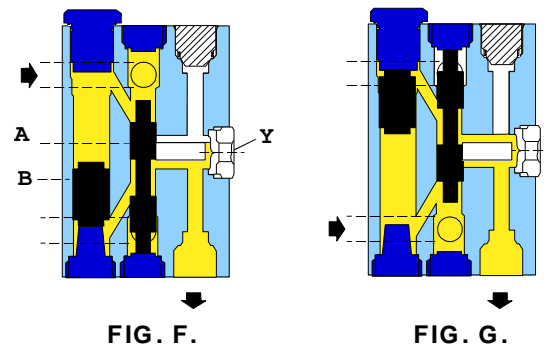

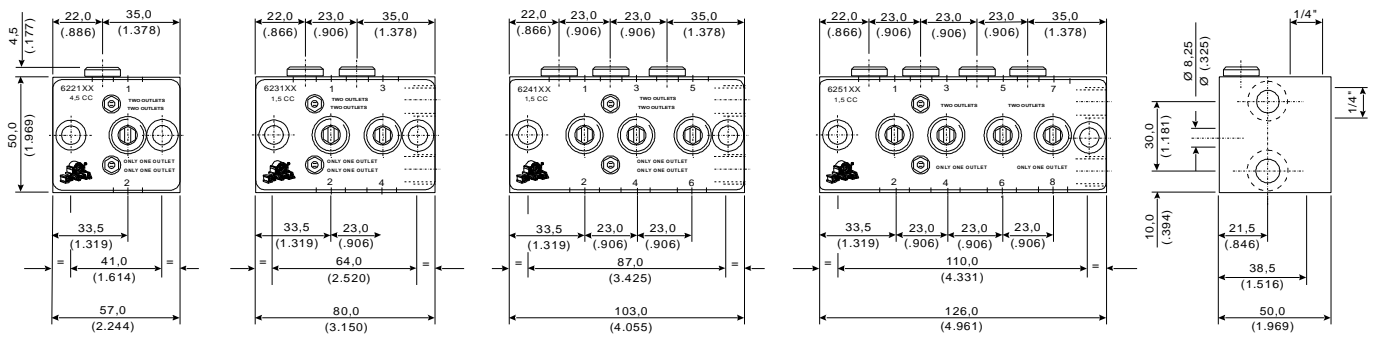

Dropsa Standard feeder blocks are normally supplied with outlets having a conical seating for Ø8 mm. (5/16") tube.

This is simple and cost effective as no fitting is required.

If required a check-valve **Part No. 92313** BSP or **Part No. 92340** NPTF can be fitted at the outlet. Order separately.

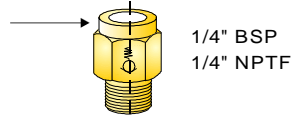

DROPSA STANDARD				
Reducer	Cone	Nut	Ø Tube	Plug
<b>671038</b>	<b>93006</b>	<b>92014</b>	Ø 6	91011
	<b>93008</b>	<b>92053</b>	Ø 8	91011

INLET 1/4"

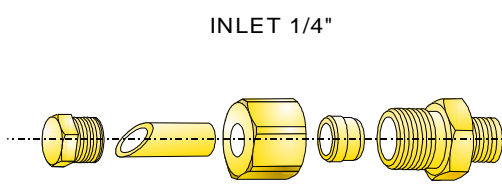

DROPSA STANDARD DIN 3852 BSP Ø mm.				
Plug	Tube Ø	Nut	Ring	Fitting
<b>926001</b>	Ø 8	<b>91402</b>	<b>91596</b>	<b>92266</b>
	Ø 10	<b>91406</b>	<b>91601</b>	<b>92242</b>
	Ø 12	<b>91411</b>	<b>91607</b>	<b>92198</b>
NPTF DRY SEAL Ø INCHES				
<b>850281</b>	Ø 5/16	<b>850201</b>	<b>850221</b>	<b>850252</b>
	Ø 3/8	<b>850202</b>	<b>850222</b>	<b>850254</b>
	Ø 1/2	<b>850203</b>	<b>850223</b>	<b>850256</b>

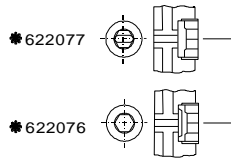

OUTLET 1/4"

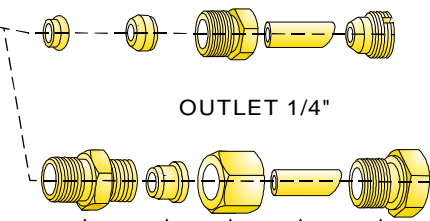

DIN 3852 BSP Ø mm				
Fitting	Ring	Nut	Ø Tube	Plug
<b>91952</b>	<b>91590</b>	<b>91396</b>	Ø 6	<b>622167</b>
<b>91959</b>	<b>91596</b>	<b>91401</b>	Ø 8	
<b>91966</b>	<b>91601</b>	<b>91406</b>	Ø 10	
NPTF DRY SEAL Ø INCHES				
<b>850250</b>	<b>850220</b>	<b>850200</b>	Ø 1/4	<b>850281</b>
<b>850252</b>	<b>850221</b>	<b>850201</b>	Ø 5/16	
<b>850254</b>	<b>850222</b>	<b>850202</b>	Ø 3/8	

- The double outlet adaptor (**622077**) is identifiable by two parallel line markings in the centre; the single outlet adaptor (**622076**) has a circular marking only.

The fixing parts which are indicated thus • are to be ordered separately.

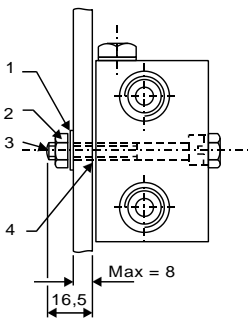

Pos.	Part No.	Qty.	Description	
• 1	<b>16012</b>	2	Spring washer	Metric
• 2	<b>16406</b>	2	Nut M8 - Hex	
• 3	<b>12552</b>	2	Screw M8 x 60	
• 4	<b>3008107</b>	2	Bushing	Inch
• 1	<b>16012</b>	2	Spring washer	
• 2	<b>16500</b>	2	Nut 5/16-24 UNF x 2-1/2	
• 3	<b>12561</b>	2	Screw 5/16-24 UNF x 2-1/2	
• 4	<b>3008107</b>	2	Bushing	

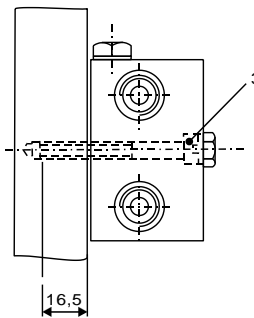

WELD PLATES FOR FEEDERS

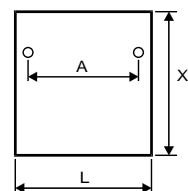

Pos.	Part No.	Dimensions (inches)		
		A	L	X
1	<b>111581</b>	41 (1.614")	60 (2.362")	140 (5.511")
2	<b>111582</b>	64 (2.520")	85 (3.346")	140 (5.511")
3	<b>111583</b>	87 (3.425")	110 (4.330")	140 (5.511")
4	<b>111584</b>	110 (4.330")	130 (5.118")	140 (5.511")

**ITALIA**  
Dropsa SpA  
t. +39 02-250791  
f.+39 02-25079767

**U.K.**  
Dropsa (UK) Ltd  
t. +44 (0)1784-431177  
f. +44 (0)1784-438598

**GERMANY**  
Dropsa GmbH  
t. +49 (0)211-394-011  
f. +49 (0)211-394-013

**FRANCE**  
Dropsa Ame  
t. +33 (0)1-3993-0033  
f. +33 (0)1-3986-2636

**CHINA**  
Dropsa Lubrication Systems  
(Shanghai) Co., Ltd  
t. +86 (021) 67740275  
f. +86 (021) 67740205

**U.S.A.**  
Dropsa USA Incorporated  
t. +1 586-566-1540  
f. +1 586-566-1541

**AUSTRALIA**  
Dropsa Australia Pty  
t. +61 (02)-9938-6644  
f. +61 (0)2-9938-6611

**BRAZIL**  
Dropsa Do Brasil Ind.e Com.Ltda  
t. +55 (0)11-563-10007  
f. +55 (0)11-563-19408