

## Characteristics

- **Temperature range:**  
-30 to +80°C.;
- **Max. pressure (inlet):**  
400 bar (5800 psi.);
- **Cycles:**  
100/min.;
- **Min. Viscosity:**  
100 cSt (462 SSU);
- **Grease Max.:**  
265 ASTM (NLGI 2)\*;
- **Connections:**  
Inlet: 1/4"  
Outlet: 5/16" - 24NF.

(\* For different type of grease please contact your supplier.

## Feeder block series AP1

The feeder body is made of special anti-friction steel.

Pistons are made of hardened steel. Bores and pistons are lapped to provide superior sealing.

The indicator turrets are provided with integral adjusting screws together with a metacrylate cover and seal.

On request an aluminium cover can be supplied.

The feeder body has a galvanized finish and features an adaptor (see Fig. F.) for single or double outlet conversion.

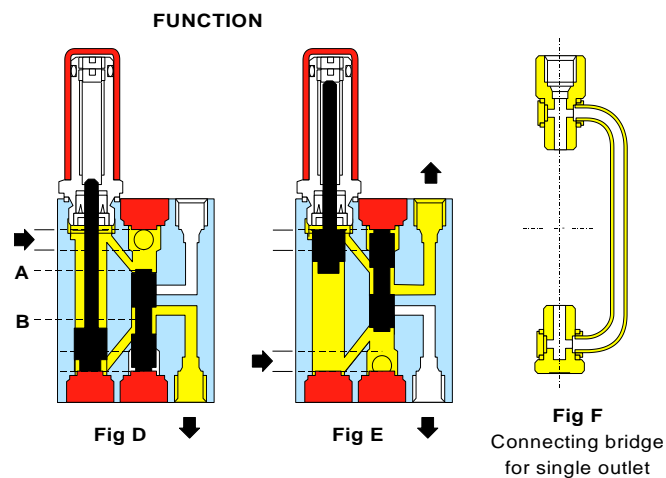

### INSTALLATION/OPERATION:

Function: (Refer to Figs. 1 and 3.) The feeder discharge is controlled by a servo-piston (A) and metering piston (B) and can be arranged to provide a single or double outlet. Fig. D-E = 2 separate outlets. Fig. F. = connecting bridge for single outlet. Feeders are normally supplied with double outlets unless otherwise specified. For single outlets use Connecting Bridge Part No. 622030 (refer to Fig. 3.).

The two outlets of each feeder block must always be used. If you need only one outlet you must use Connecting Bridge Part No. 622030. The other outlet cannot be plugged. The volume can be adjusted by turning the screw of the turret. When single outlet feeders are used, the discharge per complete cycle = 0,2 to 2 cc/stroke (.012 to .122 cu.in./stroke.).

**Dimensions:** (Refer to Fig. 2.).

**Mounting:** (Refer to Fig. 2.). Aluminium Bushings **Part No. 622017** are supplied for mounting on uneven surfaces to prevent distortion or damage due to overtightening.

## Applications

- Paper Mills ;
- Steelworks;
- Cement;
- Large lifting.

## Contacts

www.dropsa.com  
sales@dropsa.com

### ITALIA

Dropsa SpA  
t. +39 02-250791  
f. +39 02-25079767

### U.K.

Dropsa (UK) Ltd  
t. +44 (0)1784-431177  
f. +44 (0)1784-438598

### GERMANY

Dropsa GmbH  
t. +49 (0)211-394-011  
f. +49 (0)211-394-013

### FRANCE

Dropsa Ame  
t. +33 (0)1-3993-0033  
f. +33 (0)1-3986-2636

### CHINA

Dropsa Lubrication Systems  
(Shanghai) Co.,Ltd  
t. +86 (021) 67740275  
f. +86 (021) 67740205

### U.S.A.

Dropsa Corporation  
t. +1 586-566-1540  
f. +1 586-566-1541

### AUSTRALIA

Dropsa Australia Ltd.  
t. +61 (0)2-9938-6644  
f. +61 (0)2-9938-6611

### BRAZIL

Dropsa Remonlub  
t. +55 (0)11-563-10007  
f. +55 (0)11-563-19408

## Feeder block series AP1

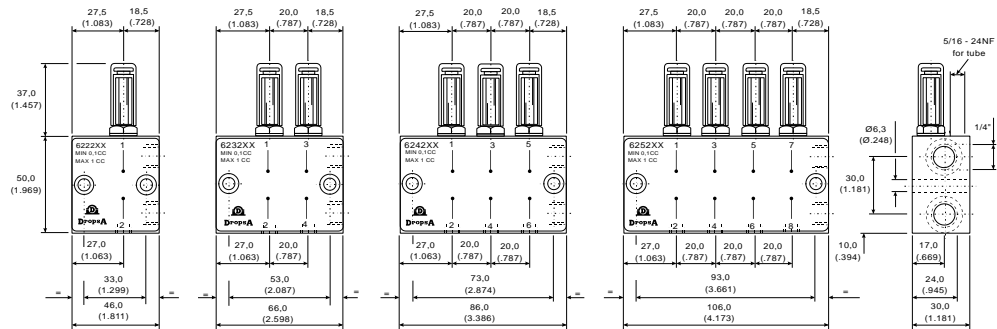

DROPSA STANDARD - DIN 3852 Ø mm				
Plug	Ø Tube	Nut	Ring	Fitting
926001	6	91396	91590	92337
	8	91402	91596	92266
	10	91406	91601	92242
NPTF DRY SEAL Ø INCHES				
850281	1/4	850200	850220	850250
	5/16	850201	850221	850252
	3/8	850202	850222	850254

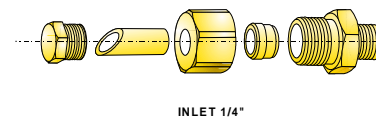

INLET 1/4"

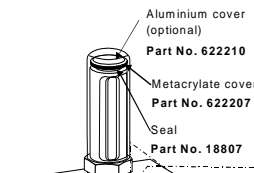

DROPSA STANDARD - Ø mm			
Cone	Bush	Ø Tube	Plug
93004	92004	Ø4	91005
NPTF DRY SEAL Ø INCHES			
93004	92026	Ø 5/32	91005

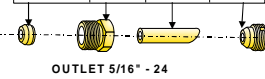

OUTLET 5/16" - 24

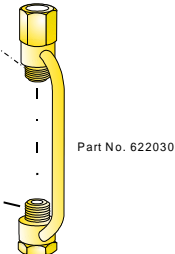

Part No. 622030

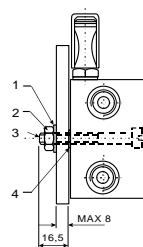

The fixing parts which are indicated thus \* are to be ordered separately.

Pos	Part No.	Qty.	Description	
*1	16009	2	Spring washer	Metric
*2	16335	2	Nut M6	
*3	12534	2	Screw M6 x 45	
4	622017	2	Bushing	
*1	16012	2	Spring washer	Inches
*2	16499	2	Nut 1/4-28 UNF Hex. 7/16	
*3	12562	2	Screw 1/4-28 UNF x 1 3/4	
4	622017	2	Bushing	

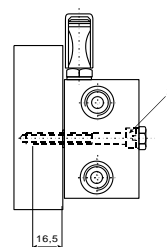

### WELD PLATES FOR FEEDERS

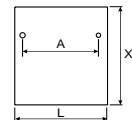

N.	Part No.	DIMENSIONS (INCHES)		
		A	L	X
1	111585	33 (1.29)	45 (1.77)	120 (4.72)
2	111586	53 (2.08)	65 (2.55)	120 (4.72)
3	111587	73 (2.87)	85 (3.34)	120 (4.72)
4	111588	93 (3.66)	105 (4.13)	120 (4.72)

## Informazioni per l'ordine

C1044PE WK 30/06

Thread	Part N°.	Weight		N° outlets
		Kg.	Lbs.	
Dropsa Standard BSP	622200	0,450	.99	1-2
	623200	0,660	1.45	2-4
	624200	0,900	1.98	3-6
	625200	1,10	2.42	4-8